

# FJ SERIES

## LED High Mast Light

**5 YEAR**  
WARRANTY



### Product Benefits

- Up to 100,000hrs @ L70, low maintenance cost
- World class, approbated quality components (LEDs /Driver /etc.)
- Modular and buckle design for easy maintenance and replacement
- Wide choice of optics to suit more applications (asymmetrical and symmetrical)
- Lighting fixture can be rotatable 360 degree, easy installation
- 5 years warranty

### Product Features

- Luminaire efficacy: Up to 140 lm /w
- Lifetime more than 100,000 hours
- Impact resistance: IK10
- Type of protection: IP66



## Product Datasheet

Model No	MK-FJ-400	MK-FJ-600	MK-FJ-800
Nominal Wattage	400W	600W	800W
3030 Version	Efficiency Lumen 140 lm /w 56000 lm	140 lm /w 84000 lm	140 lm /w 112000 lm
5050 Version	Efficiency Lumen 150 lm /w 60000 lm	150 lm /w 90000 lm	150 lm /w 120000 lm
Fixture Dimension (mm)	672x430x304	672x430x304	728x430x304
Fixture Weight (kg)	17	20	25
Packing Type	1unit /ctn	1unit /ctn	1unit /ctn
Packing Dimension (mm)	745x505x390	745x505x390	800x505x390
Packing Weight (kg)	19	23	28

\*Above values are calculated based on the product with CCT over 3000K, values of 3000K are 5% lower than above values.

\*Luminous Efficacy of Asymmetrical is 5% lower than other Light Distributions.

\*Values shown are subject to ±5% tolerance.

## Electrical Data

Nominal Voltage	AC 100-240V /277V   50 /60Hz
LED	Philips Lumileds
Driver	Meanwell /SOSEN
Power Factor (PF)	>0.95
THD	<15
SPD	10KV
Optics	30°/45°/60°/90°/140°x80°/120°x60°
Standard Deviation of Color Matching	<5 SDCM
CRI	Ra>70 (Default) /Ra>80
CCT	3000K, 4000K, 5000K, 5700K, 6500K

## General Data

Body Material	High pressure die-cast aluminum
Housing Color	Sliver or others available on request
Cover Material	UV-resistant Polycarbonate
Working Environment	-40°C ~ +50°C, 10% ~90%RH
Lifespan L70 at 25 °C	>100, 000 h
Mounting Type	Side entry pole mounted
Pole Diameter	60-100mm
Dimmable	1-10V Dimming (Default) /Timer Dimming
Protection Class	Class I (Default) /Class II
Standards	CE, RoHS, LM80, TM-21
Available on request	NEMA socket (3/5/7pins), ZHAGA socket, Short cap, Photocell, OLC

## Application



Airport



Wharf



Plaza

- Roads and highways
- Parking lots
- Sports stadiums
- Railroad yards
- Shipyards
- Warehouses
- Truck stops and rest areas
- Outdoor parks and recreation areas
- Playgrounds
- Storage facilities

Product Datasheet

Structure Drawing

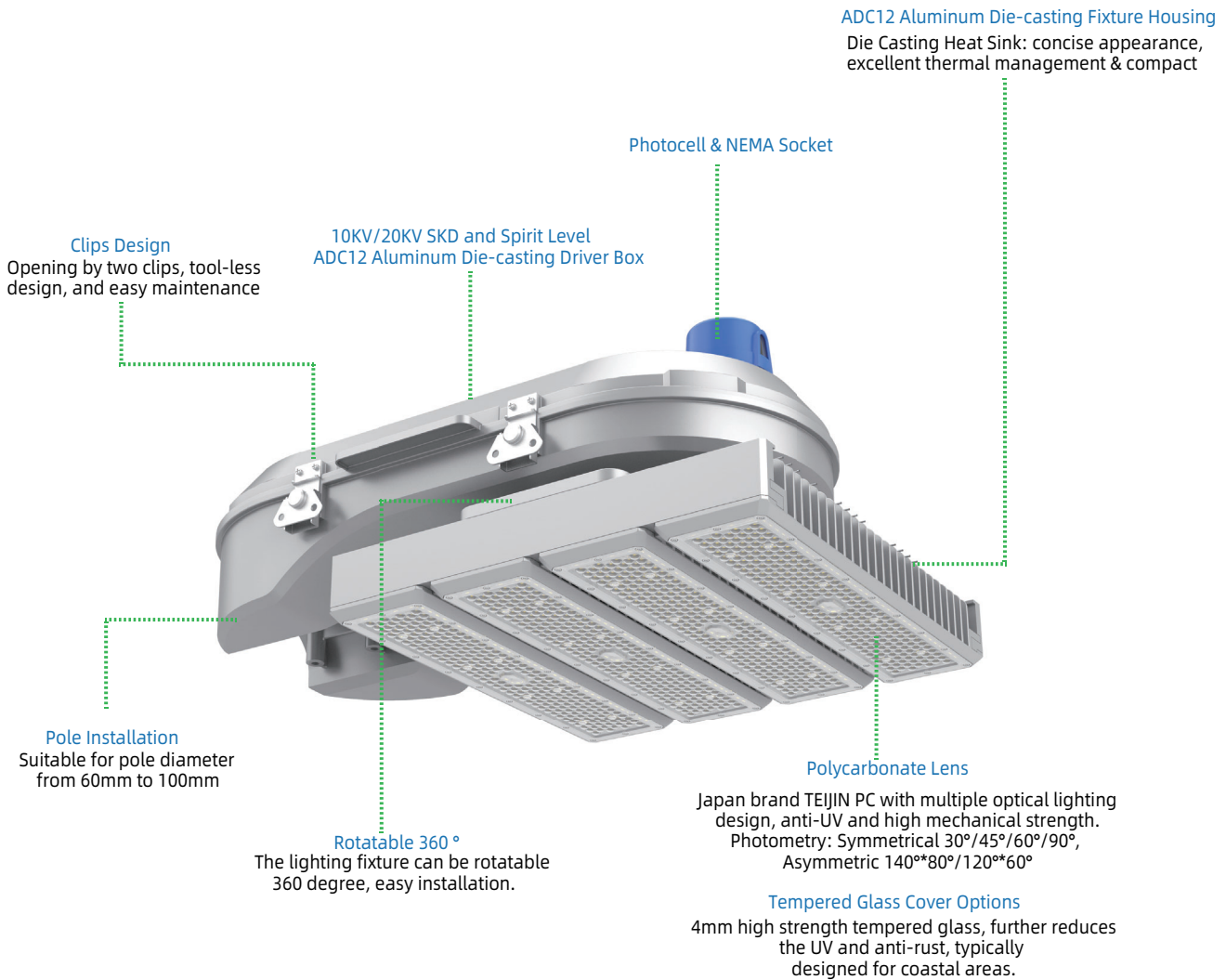

Installation

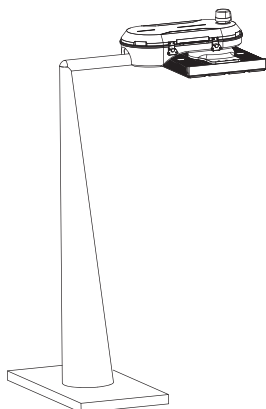

Product Datasheet

Light Distributions

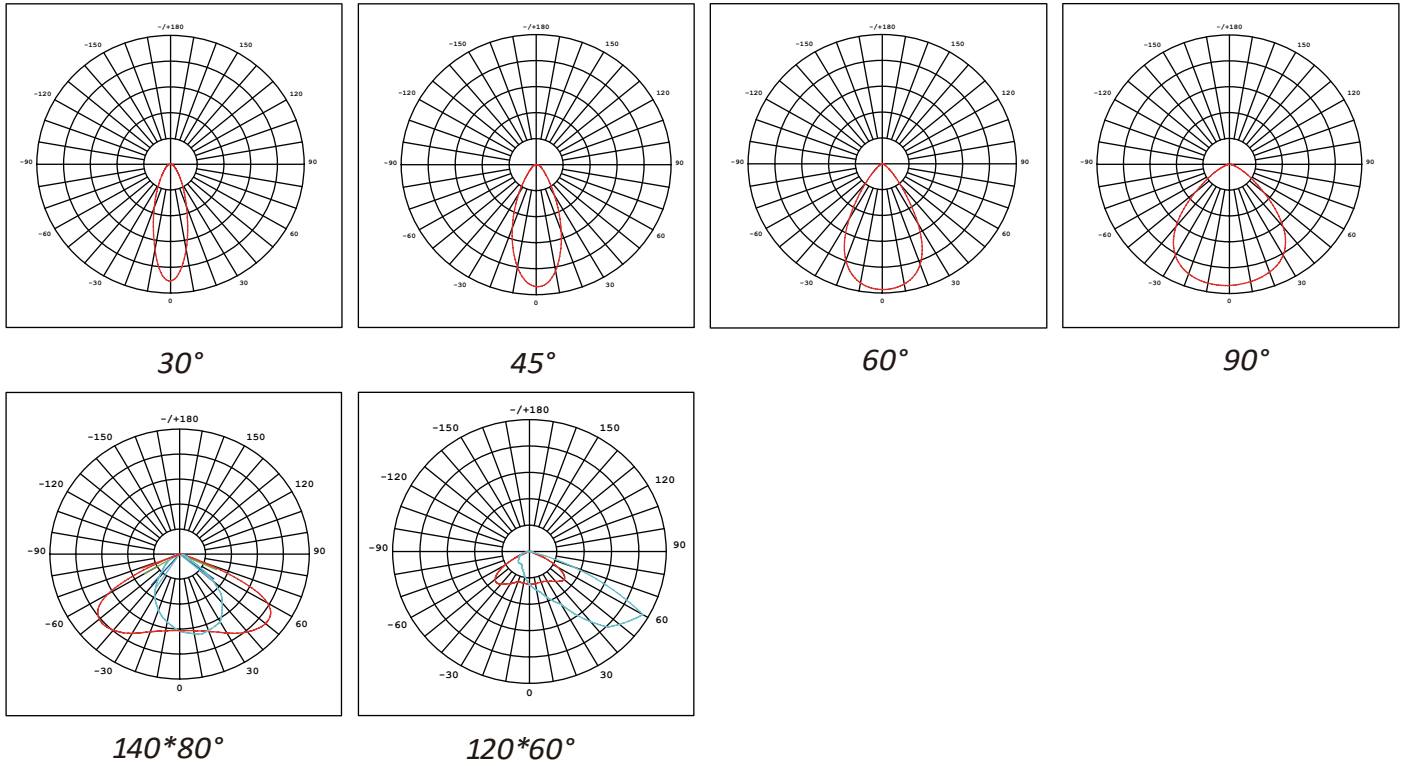

Dimensions(mm)

